

SOLUTIONS FOR MINING &
CONSTRUCTION

CATALOGUE



If you would like further information on any of our products and services please don't hesitate to contact us on:

Tel: +44 (0)2476 356344
Fax: +44 (0)2476 375042
Web: www.abgtools.com
Email: info@abgtools.com

ABG Construction & Mineral Tools Ltd
Whitacre Road Ind. Estate,
Nuneaton,
Warwickshire, CV11 6BY



SOLUTIONS FOR MINING &
CONSTRUCTION

INDEX

RADIAL TOOLS	3,4,5
POINT ATTACK TOOLS	6,7,8
REAR LOCK DRY & HF8-BOX.....	9
HOLDERS.....	10
ROTARY TOOLS.....	11,12
CEMENTED CARBIDE TIP CHART.....	13,14



If you would like further information on any of our products and services please don't hesitate to contact us on:

Tel: +44 (0)2476 356344
Fax: +44 (0)2476 375042
Email: info@abgtools.com

Address
ABG Construction & Mineral Tools Ltd
Whitacre Road Ind. Estate
Nuneaton
Warwickshire CV11 6BY

RADIAL TOOLS

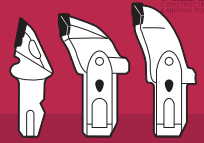

To Order Call: **024 7635 6344**

RADIAL TOOLS

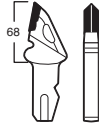

TYPE: AT68

Shank Size: 32 x 19

Suitable Tips: 08

Order Code: RT-AT68-08

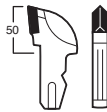

TYPE: QR6/50

Shank Size: 32 x 19

Suitable Tips: 04, 09

Order Code: RT-QR6/50-XX(TIPSIZE)

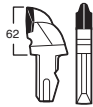

TYPE: QR6

Shank Size: 32 x 19

Suitable Tips: 04, 08, 09, 11

Order Code: RT-QR6-XX(TIPSIZE)



TYPE: LR135

Shank Size: 32 x 19

Suitable Tips: 36

Order Code: RT-LR135-36

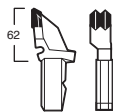

TYPE: QR6D L/H

Shank Size: 32 x 19

Suitable Tips: 02, 13, 35

Order Code: RT-QR6DLH-XX(TIPSIZE)

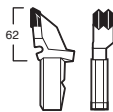

TYPE: QR6D R/H

Shank Size: 32 x 19

Suitable Tips: 02, 13, 35

Order Code: RT-QR6DRH-XX(TIPSIZE)

RADIAL TOOLS

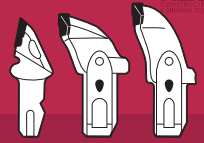

To Order Call: **024 7635 6344**

RADIAL TOOLS SHORT SHANK STYLE

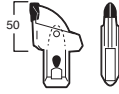

TYPE: BS200

Shank Size: 33 x 21

Suitable Tips: 02,03,27,28,29,35

Order Code: RT-BS200-XX(TIPSIZE)

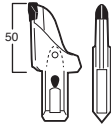

TYPE: HB200

Shank Size: 41 x 25

Suitable Tips: 04, 09

Order Code: RT-HB200-XX(TIPSIZE)

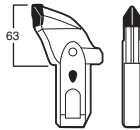

TYPE: HB250

Shank Size: 41 x 25

Suitable Tips: 04,05,18,30,33,34

Order Code: RT-HB250-XX(TIPSIZE)

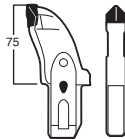

TYPE: HB300

Shank Size: 41 x 25

Suitable Tips: 04,05,18,25,30,31,32,33,34,37

Order Code: RT-HB300-XX(TIPSIZE)

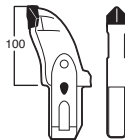

TYPE: HB400

Shank Size: 41 x 25

Suitable Tips: 04,05,18,25,30,31,32,33,34

Order Code: RT-HB400-XX(TIPSIZE)

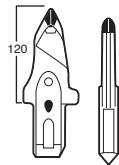

TYPE: HB450

Shank Size: 41 x 25

Suitable Tips: 04,05,18,25,30,31,32,33,34

Order Code: RT-HB450-XX(TIPSIZE)

RADIAL TOOLS

FORWARD ATTACK TOOLS

RADIAL TOOLS

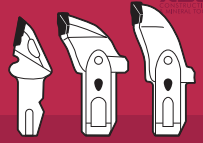

To Order Call: **024 7635 6344**

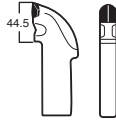

TYPE: SCCP

Shank Size: 25.4 x 12.7

Suitable Tips: 38

Order Code: RT-SCCP-38

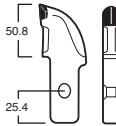

TYPE: CC19HP

Shank Size: 25.4 x 12.7

Suitable Tips: 38

Order Code: RT-CC119HP-38

RADIAL TOOLS



TYPE: 'A'

Shank Size: 25.4 x 12.7

Suitable Tips: 02,03,13,26,29,35

Order Code: RT-A-XX(TIPSIZE)

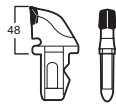

TYPE: WG21

Shank Size: 29 x 16

Suitable Tips: 02,35,38

Order Code: RT-WG21-XX(TIPSIZE)



TYPE: HSMK2

Shank Size: 25.4 x 12.7

Suitable Tips: 02,26,29,35

Order Code: RT-HSMK2-XX(TIPSIZE)

POINT ATTACK TOOLS

To Order Call: **024 7635 6344**

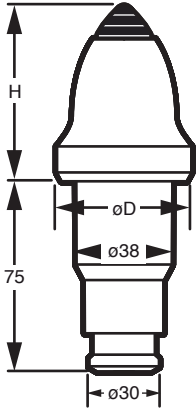

TYPE: W47 OR A47

Shank Size: 38x75

Available "H" Lengths: 64, 69, 79, 89, 102

Order Code: PA-A47XX(H LENGTH)-XX(TIP SIZE)



Tip Size: 18 x 23



Tip Size: 22 x 27

TYPE: S47

Shank Size: 38x75

Order Code: PA-S47XX(H LENGTH)-XX(TIP SIZE)



Tip Size: 18 x 30



Tip Size: 22 x 34



Tip Size: 26 x 38

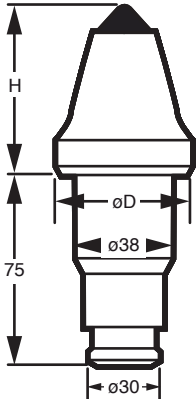

TYPE: W46

Shank Size: 38x75

Order Code: PA-W46XX(H LENGTH)-12.5



Tip Size: 12.5 x 17.5

TYPE: S46

Shank Size: 38x75

Order Code: PA-S46XX(H LENGTH)-12.5



Tip Size: 12.5 x 21.5

POINT ATTACK TOOLS

To Order Call: **024 7635 6344**

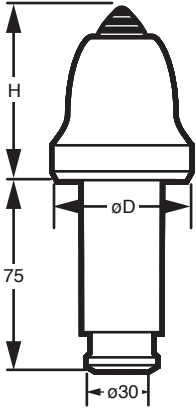

TYPE: W47-30

Shank Size: 38x75

Available "H" Lengths: 64, 69, 79, 89, 102

Order Code: PA-W47XX(H LENGTH)-XX(TIP SIZE)



Tip Size: 18 x 23



Tip Size: 22 x 27

TYPE: S47-30

Shank Size: 38x75

Order Code: PA-S4730XX(H LENGTH)-XX(TIP SIZE)



Tip Size: 18 x 30



Tip Size: 22 x 34



Tip Size: 26 x 38

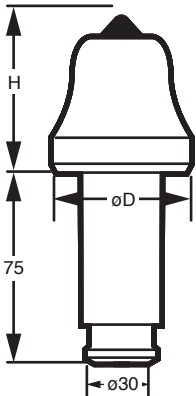

TYPE: W46-30

Shank Size: 38x75

Order Code: PA-W46-30XX(H LENGTH)-12.5



Tip Size: 12.5 x 17.5

TYPE: S46-30

Shank Size: 38x75

Order Code: PA-S4630XX(H LENGTH)-12.5



Tip Size: 12.5 x 21.5

POINT ATTACK TOOLS

To Order Call: **024 7635 6344**

TYPE: S1 OR A11K

Shank Size: 38x80

Available "H" Lengths: 64, 79, 89

Order Code: PA-A11KXX(H LENGTH)-XX(TIP SIZE)

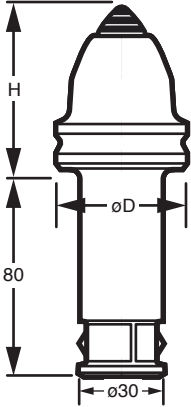

Tip Size: 18 x 23



Tip Size: 22 x 27



Tip Size: 18 x 30



Tip Size: 22 x 34



Tip Size: 26 x 38

REAR LOCK DRY & HF8-BOX

To Order Call: **024 7635 6344**

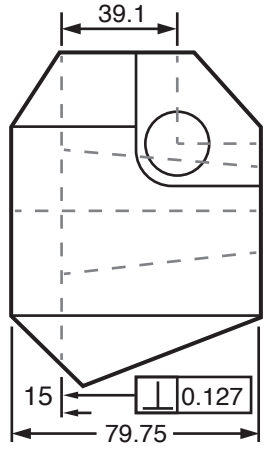

REAR LOCK DRY SYSTEM

TOOL TYPE: FA40

- Shank Size:** 40mm
- Suitable Tips:** 04, 22, 25
- Order Code:** RT-FA40-XX(TIPSIZE)

HOLDER TYPE: FAB40D

- Shank Size:** 40mm
- Order Code:** RT-FAB-40D

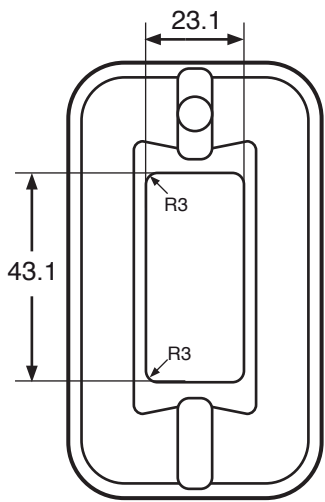

HF8-BOX

TOOL TYPE: HF8

- Shank Size:** 48mm
- Suitable Tips:** 04, 22, 25
- Order Code:** HF8-HW0NR25

The products contained in this catalogue are a sample of the most popular items. Any product that is not listed can be produced and a skilled engineer is only a phone call away.

At A.B.G. Mineral Tools, we are also keen to undertake development work and with over 30 years in the mineral tool trad, with one of the best known suppliers, our engineers have a wealth of knowledge that is brought about through experience which is invaluable to our customers

HOLDERS

To Order Call: **024 7635 6344**

HOLDERS:

This is a selection of popular holders, for any other holders please call.

A3038WD06

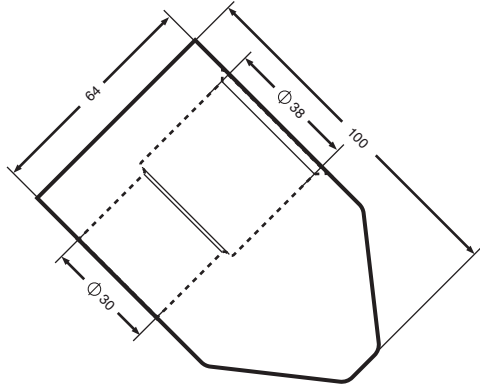
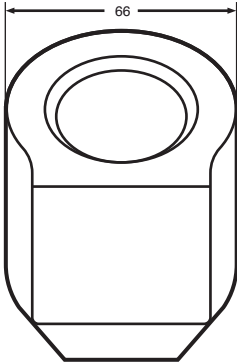

A30WA01

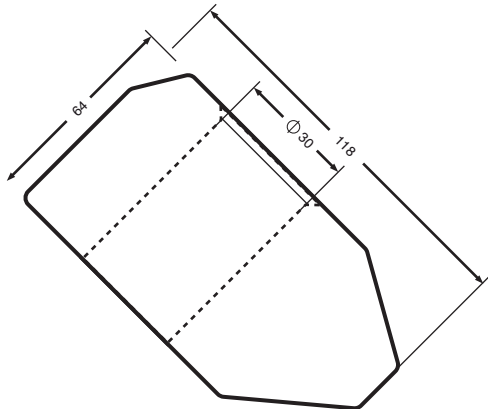
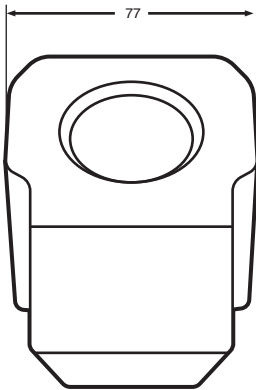







ROTARY TOOLS

To Order Call: **024 7635 6344**

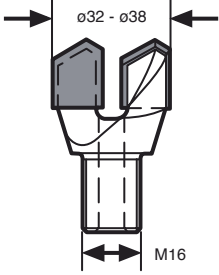
Drawing Dimensions (mm)	Tip Geometry	Description and Features	Ordering Code
<p>Two pronged bit with negative rake male whitworth threads.</p>	<p>ND27</p>	<p>ø27mm ø28mm ø29mm</p>	<p>D4WB-1327-27XX D4WB-1328-27XX D4MB-1329-27XX</p>
<p>Two pronged bit with 2.5 negative rake male M16 threads.</p>	<p>ND26</p>	<p>ø26mm ø27mm ø28mm ø29mm ø30mm</p>	<p>D4MB-1626-26XX D4MB-1627-26XX D4MB-1628-26XX D4MB-1629-26XX D4MB-1630-26XX</p>
<p>Two pronged bit with 7 positive rake male M16 threads. Good for softer conditions</p>	<p>ND97</p>	<p>ø27mm</p>	

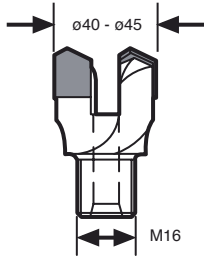
ROTARY TOOLS

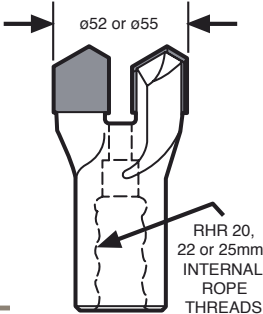
To Order Call: **024 7635 6344**

Drawing Dimensions (mm)	Tip Geometry	Description and Features	Ordering Code
	 <p>ND09</p>	<p>ø32mm</p> <p>ø35mm</p> <p>ø38mm</p> <p>ø35mm</p> <p>ø38mm</p>	<p>D4MB-1632-09XX</p> <p>D4MB-1635-09XX</p> <p>D4MB-1638-09XX</p> <p>D2MB-1635-09XX</p> <p>D2MB-1638-09XX</p>
 <p><i>Two pronged bit with 3 negative rake angle male M16 threads.</i></p>	 <p>ND91</p>	<p>ø40mm</p> <p>ø41mm</p> <p>ø42mm</p> <p>ø43mm</p> <p>ø45mm</p>	<p>D4MB-1640-91XX</p> <p>D4MB-1641-91XX</p> <p>D4MB-1642-91XX</p> <p>D4MB-1643-91XX</p> <p>D4MB-1645-91XX</p>
 <p><i>Two winged bit with 3 negative rake angle.</i></p>	 <p>ND32</p>	<p>ø52mm / RHR20F threads</p> <p>ø55mm / RHR20F threads</p> <p>ø52mm / RHR22F threads</p> <p>ø55mm / RHR22F threads</p> <p>ø52mm / RHR25F threads</p>	<p>D4RB-2052-32XX</p> <p>D4RB-2055-32XX</p> <p>D4RB-2252-32XX</p> <p>D4RB-2255-32XX</p> <p>D4RB-2552-32XX</p>

CEMENTED CARBIDE TIP CHART

CONTINUOUS MINING

To Order Call: **024 7635 6344**



NP 01



NP 02



NP 03



NP 04



NP 05



NP 07

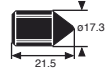

NP 11



NP 12



NP 13



NP 14

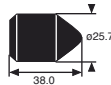

NP 17



NP 18

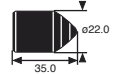

NP 19



NP 21



NP 22

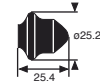

NP 23



NP 24



NP 26

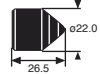

NP 30



NP 32



NP 33



NP 35



NP 36

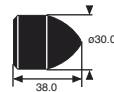

NP 40

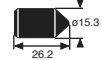

NP 41



NP 42



NP 43



NP 44



NP 45



NP 46

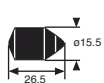

NP 49



NP 50



NP 51

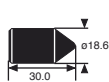

NP 52

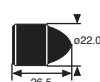

NP 53



NP 54

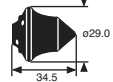

NP 56

CEMENTED CARBIDE TIP CHART

RADIAL AND ROTARY DRILLING

To Order Call: **024 7635 6344**

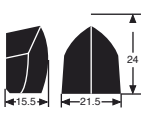

NR 04

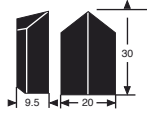

NR 09

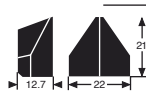

NR 18

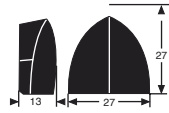

NR 22

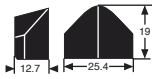

NR 25

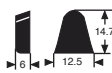

NR 26

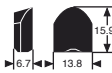

NR 38

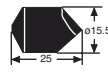

NR 40

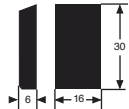

NR 41

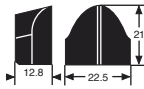

NR 46

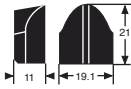

NR 47

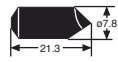

NR 48



NR 49



ND 08

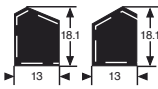

ND 09



ND 10



ND 11



ND 15



ND 16



ND 17



ND 26



ND 27



ND 28



ND 29



ND 30



ND 32



ND 35

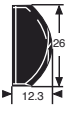

ND 71



ND 74



ND 83



ND 85



ND 91



ND 94



ND 97



ND 98